

\$20,000 - 11969 Jasper Avenue, Edmonton

MLS® #E4445471

\$20,000

0 Bedroom, 0.00 Bathroom,
Condo / Townhouse on 0.00 Acres

Wâhkwa'antâwin, Edmonton, AB

Underground parking stall only in Pearl Tower.
A great addition for a current owner to own an additional stall or to rent out as an owner or otherwise. You don't have to live in the building to purchase this stall. Condo fee is 189.60 annually and taxes are \$106.60 annually.



Built in 2015

Essential Information

MLS® #	E4445471
Price	\$20,000
Bathrooms	0.00
Acres	0.00
Year Built	2015
Type	Condo / Townhouse
Sub-Type	Parking Stall
Status	Active

Community Information

Address	11969 Jasper Avenue
Area	Edmonton
Subdivision	Wâhkwa'antâwin
City	Edmonton
County	ALBERTA
Province	AB
Postal Code	T5K 0P1

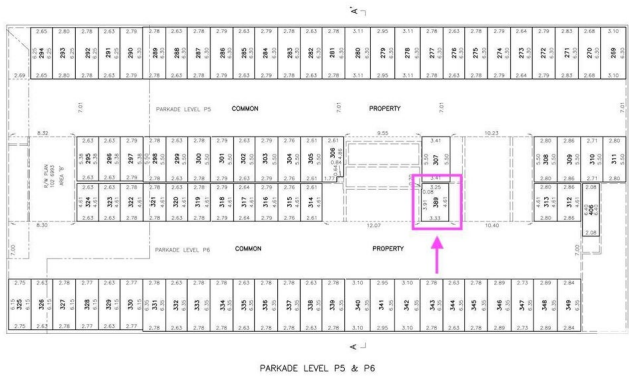

Amenities

Parking Spaces 1
Parking Single Indoor, Underground

Exterior

Exterior Features See Remarks

Additional Information

Date Listed June 30th, 2025
Days on Market 13
Zoning Zone 12
Condo Fee \$16

DATA IS DEEMED RELIABLE BUT IS NOT GUARANTEED ACCURATE BY THE REALTORS® ASSOCIATION OF EDMONTON. COPYRIGHT 2025 BY THE REALTORS® ASSOCIATION OF EDMONTON. ALL RIGHTS RESERVED.Trademarks are owned or controlled by the Canadian Real Estate Association (CREA) and identify real estate professionals who are members of CREA (REALTOR®, REALTORS®) and/or the quality of services they provide (MLS®, Multiple Listing Service®)
Listing information last updated on July 13th, 2025 at 2:32am MDT